

OS.4016.CTF

APPL. IN LUCE
SIDE FIXING

DOPPIA GUIDA
TELESCOPICA
REGOLABILE IN
ALTO ED IN BASSO
(BREVETTO).
TELO CON BORDI
TERMOALDATI E
BORCHIATO.

TOP AND BOTTOM
ADJUSTABLE TELESCOPIC
SIDE GUIDES - PATENTED -
HEAT-SEALED FABRIC
EDGES, COMPLETE WITH
METAL STUDS.

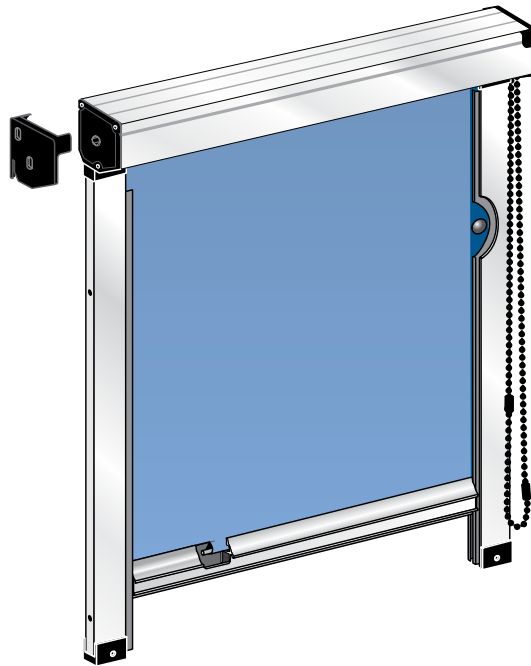

ALUMINIUM

Aumento prezzo / Price increase

001 - Anodizzato Argento Natural Anodized - STANDARD	---
002 - Anodizzato Bronzo Bronze Anodized	---
006 - Elettr. Testa di Moro Dark brown Anodized	+12%
201 - RAL 9010 Bianco Lucido Gloss white coated	+9%
200 - RAL 1013 Panna Lucido Gloss cream coated	+9%
999 - RAL a scelta: Attenzione! richiedere sempre tempi di consegna! Other colours: ask for delivery time!	+25%
	+100 € Nette, fisse, NET

PLASTIC

All. BIANCO e PANNA White/Cream aluminium	BIANCHI White
Tutti altri colori allum. All other aluminium colours	NERI Black
All. RAL: definire colore nell'ordine. Ral Alum.: specify plastic colour	

STANDARD GUIDE

E

A RICHIESTA:
CATENELLA IN METALLO
On request - Metal Chain

CL3: Max
resistenza
al vento
Class 3
(top class)
wind resistance



INTERNO
INDOOR

OPTIONALS

TENSORE CATENA Con molla interna

70200.210 Nero Black
70200.201 Bianco White
+ 13,0 € Cad. Each

CHAIN TENSOR (internal spring)

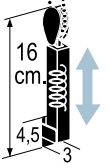

MONTANTE

Per affiancare
più tende

20056 + 20057
+ 26,5 € m/l

UPRIGHT For joined blinds

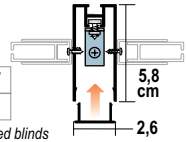

STAFFE - BRACKETS

70166
+ 11,0 € 2 PZ. 2 PCS

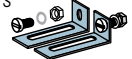

ALTERNATIVES

OS.4015.CTF

SUPPORTI A SOFFITTO
Consigliati per tende a catenella di
grandi dimensioni
VEDI TABELLE PAGINA SEGUENTE

TOP FIXING BRACKETS
Suitable for big dimensions
SEE CHARTS NEXT PAGE

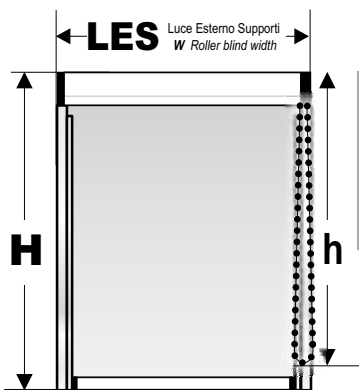
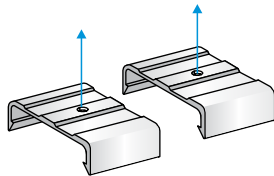

$h \approx H$

Lato standard DESTRO

In alternativa indicare sull'ordine
Misura, Colore e Lato desiderati

Op. System at the R.H. side (unless otherwise stated)

- Carico di rottura della catenella:
di plastica 25 Kg - di metallo 9 Kg
- Chain breaking load
Plastic chain 25 Kg - metal chain 9 Kg

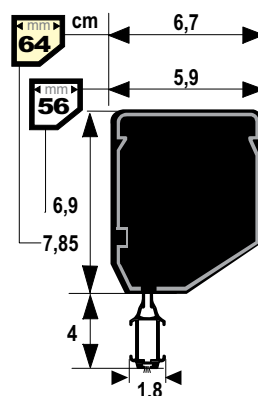

APPLICAZ. LATERALE
SIDE FIXING BRACKETS

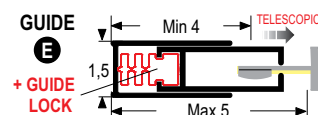
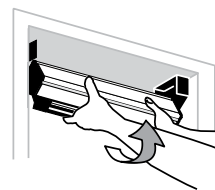

+ GUIDE
LOCK

CODICI TESSUTO:

Campionario **TECHNOCOLOURS**
Vista **INTERNA**: tessuto così come
mostrato nel campionario.
TESSUTO GIRATO: scegliere TR sul
modulo d'ordine.

FABRIC: see **TECHNOCOLOURS**
collection. Fabric is intended viewing
from inside. Back side fabric: cross
BS on the form.

MODULO ORDINE:

Ordini veloci e completi con l'ap-
posito modulo che trovi in fondo al
capitolo o sul sito web.

ORDER FORM:

Use the order form at the end of
chapter or on the web site.

Suncover si riserva la facoltà di
modificare/adeguare le informa-
zioni tecniche e le caratteristi-
che dei prodotti, anche senza
preavviso alcuno.

Suncover reserves the right to
change specifications and
characteristics of the products
without any notice.